



Nameplate Specifications

Output HP	0.50 Hp	Output KW	0.37 kW
Frequency	50 Hz	Voltage	110/220 V
Current	7.8,3.9 A	Speed	2850 rpm
Service Factor	1.25	Phase	1
Efficiency	68 %	Power Factor	0
Duty	Continuous	Insulation Class	B
KVA Code	L	Frame	48
Enclosure	Drip Proof	Thermal Protection	N/R
Ambient Temperature	40 °C	Drive End Bearing Size	6203
Opp Drive End Bearing Size	6203	UL	Recognized
CSA	Yes	CE	N

Technical Specifications

Electrical Type	Capacitor Start Induction Run	Starting Method	SM
Poles	2	Rotation	Counterclockwise/Clockwise
Mounting	Rigid Base	Motor Orientation	ANY
Drive End Bearing	BALL	Opp Drive End Bearing	Ball
Frame Material	Rolled Steel	Overall Length	10.06 in
Frame Length	6.62 in	Shaft Diameter	0.500 in
Shaft Extension	1.5 in		
Connection Drawing	52A105381AA	Outline Drawing	52A109399P2

This is an uncontrolled document once printed or downloaded and is subject to change without notice. Date Created:03/11/2020

SIZE	DRAWING NO.	REV	SHEET
A	52A109399	1	1

REV.	DESCRIPTION	DATE	APPROVED
1	"XH" DIM CHANGE AS PER ISO5-1772	07/26/05	RAJKUMAR

This document is the property of REGAL BELLOIT Corporation ("REGAL") including its subsidiaries and divisions and contains proprietary information of REGAL. This document is loaned on the express condition that neither the information contained herein shall be disclosed to others without the prior written consent of REGAL. REGAL shall not be held liable for any damage or injury caused by the use of this document. This document shall be returned to REGAL upon its request. This document may be subject to certain restrictions under U.S. export control laws and regulations.

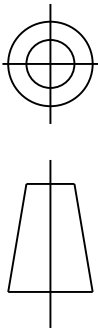

THIRD ANGLE PROJECTION

VIEW SHOWING P. E. VENTILATION OPENINGS

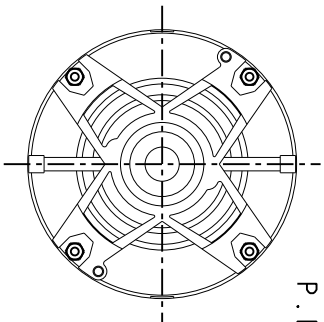

* IS A CLEARANCE DUE TO VARIATION IN PARTS AND ASSEMBLY.

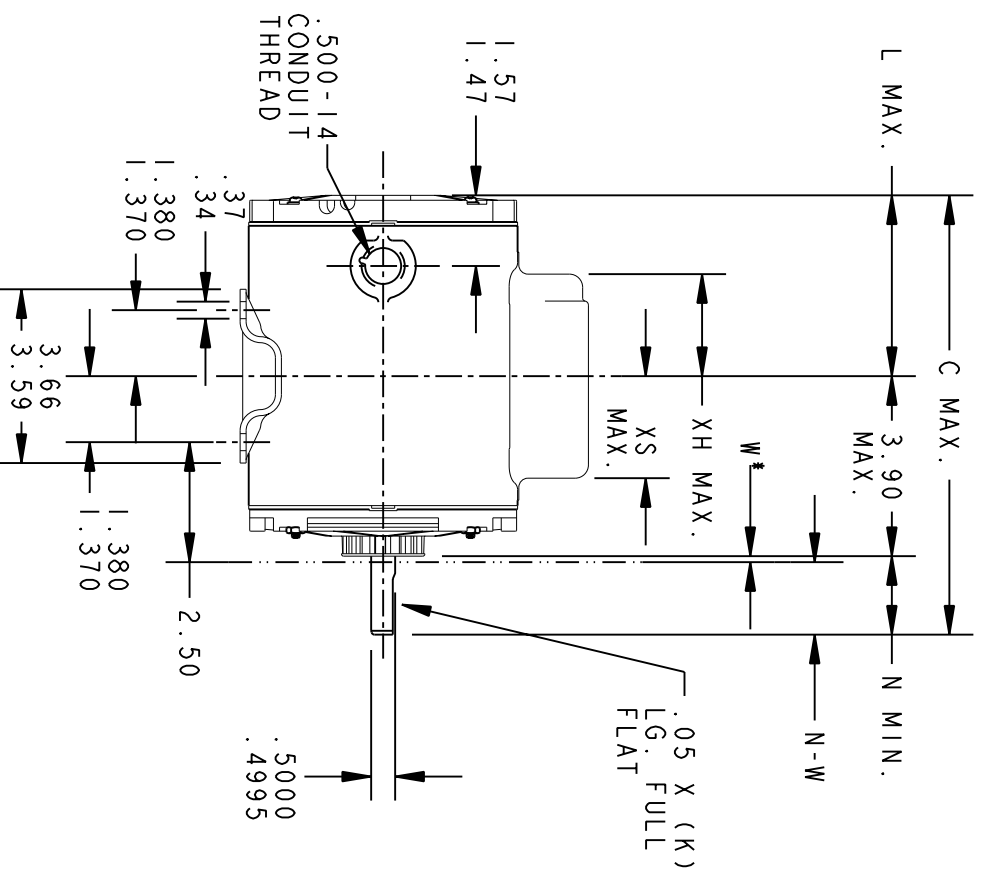
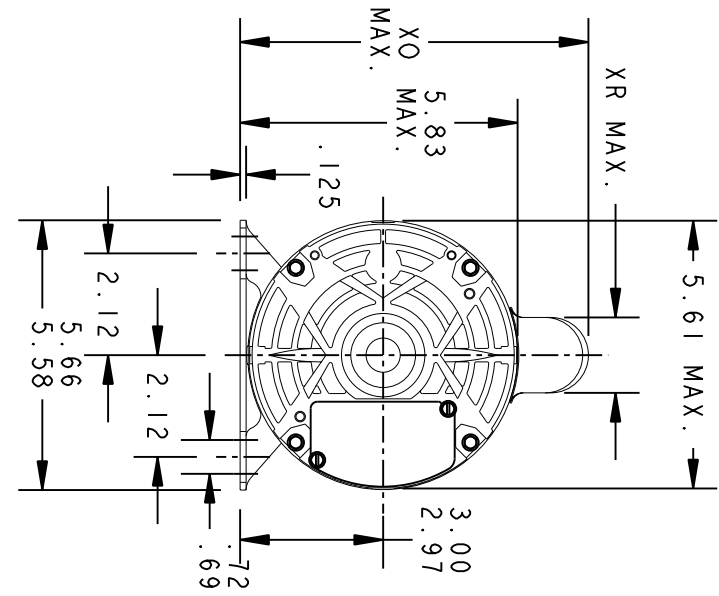

2	KC	37	48	10.06	1.16	5.05	1.50	1.63/1.41	3.37	7.31	1.60	2.33
1	KC	36	48	9.66	1.16	4.65	1.50	1.63/1.41	2.87	7.31	1.60	1.35
P	TYPE	GE	NEMA	C	K	L	N	N-W	XH	XO	XR	XS

FOR ADDITIONAL INFO REFER TO:	SIGNATURES	DATE
APPLIED PRACTICES	MODEL	07/26/05
DIMENSIONS ARE IN INCHES	RAJKUMAR	
	DETAIL	

REGAL BELLOIT CORPORATION

OUTLINE

FORM N - GENERAL PURPOSE MOTOR - DRIP PROOF WELDED BASE - BALL OR SLEEVE BEARING

TOLERANCE ON:	CHECKED
1 PL DECIMALS ± 0.1	ENGRG
2 PL DECIMALS ± 0.01	MFG
3 PL DECIMALS ± 0.005	QUALITY
ANGLES ± 0.5	ISSUED
FRACTIONS ±	RAJKUMAR
FINISH	07/26/05
MATERIAL	SOLID MODEL: MODEL NAME

SCALE:	A
SIZE DRAWING	A
TITLE	OUTLINE
FORM N - GENERAL PURPOSE MOTOR - DRIP PROOF WELDED BASE - BALL OR SLEEVE BEARING	
52A109399	REV 1
SHEET 1 of 1	

THIRD ANGLE PROJECTION

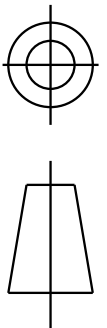

REVISIONS

REV.	DESCRIPTION	DATE	APPROVED
2	UPDATED FORMAT	01/04/06	MAM

EITHER ROTATION - DUAL VOLTAGE
TYPE KC OR KH
T3 OR ORANGE

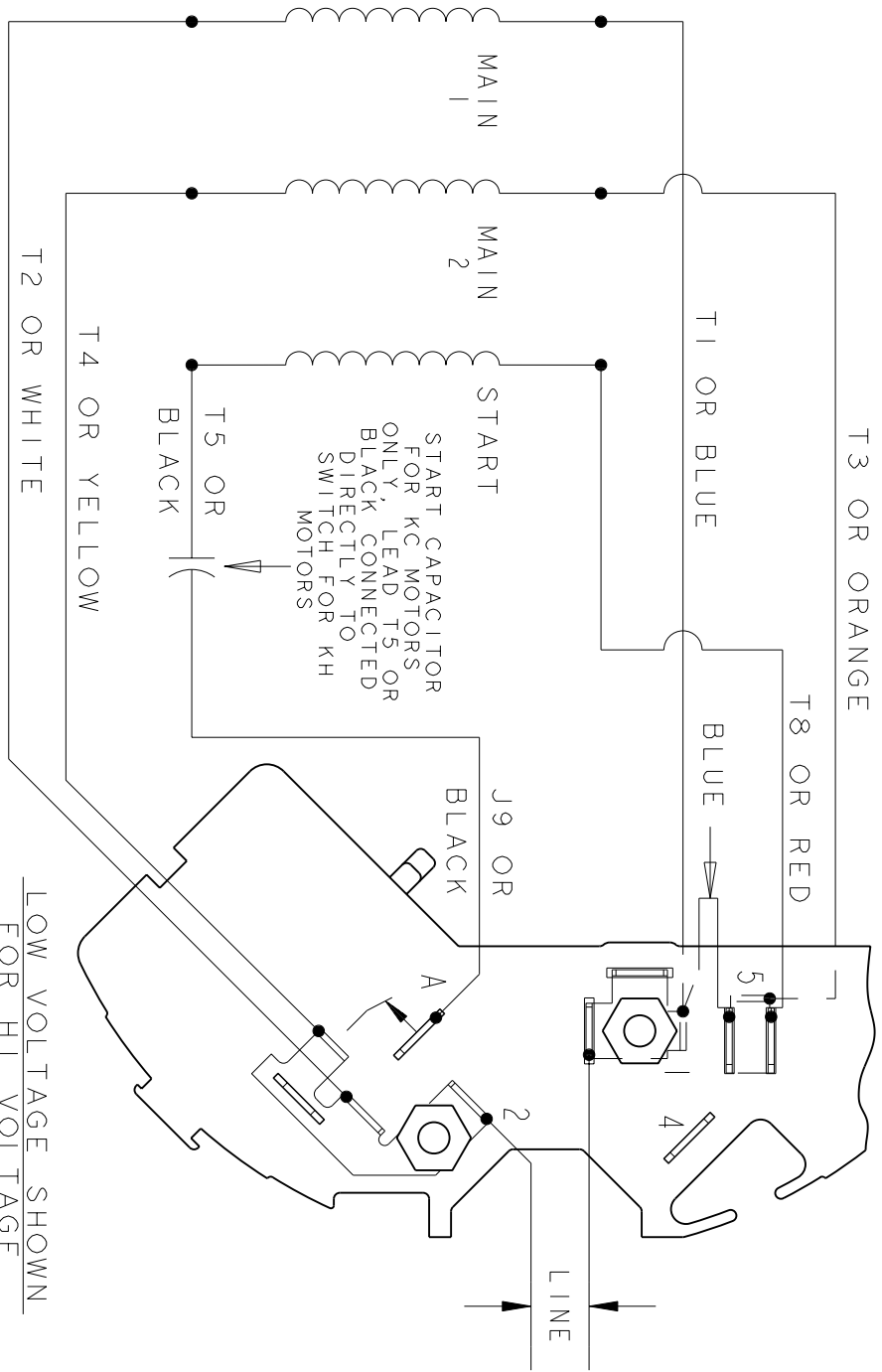

- NOTE #1 - FOR HI VOLTAGE REMOVE BLUE FROM TERMINAL #5 AND PLACE ON TERMINAL #4, REMOVE WHITE (T2) FROM TERMINAL #2 AND PLACE ON TERMINAL #5.
- NOTE #2 - TO REVERSE ROTATION INTERCHANGE RED (T8) AND BLACK (J9-KC OR T5-KH) LEADS.
- NOTE #3 - WHEN MORE THAN ONE CAPACITOR IS USED CONNECT IN PARALLEL.

REF. DIAG. - 121A852

SWITCH (C) - 115D958AB
CONNECTION LABEL - 52X332050

LOW VOLTAGE SHOWN
FOR HI VOLTAGE
SEE NOTE #1

SIGNATURES		DATE
MODEL	M.D. PAPE	06/29/87
DETAIL		
CHECKED		
ENGRG		
MFG		
FOR ADDITIONAL INFO REFER TO:		
APPLIED PRACTICES	QUALITY	
DIMENSIONS ARE IN INCHES	ISSUED	M.D.P. 06/29/87
MATERIAL	SOLID MODEL: 52A105381AA	



REGAL-BELOIT CORPORATION

TITLE CONNECTION DIAGRAM

FME: 30 FRAME SWITCH REDESIGN

SIZE	DRAWING	SCALE	REF. No.	SHEET	REV
A		1.000		1 of 1	2